

LOT	LOCATION	SQ FT	FLOOR
1179	6 JUNIPER WAY	1100	3RD
1180	5 JUNIPER WAY	1100	2ND
1181	4 JUNIPER WAY	1100	1ST
1182	3 JUNIPER WAY	1100	3RD
1183	2 JUNIPER WAY	1100	2ND
1184	1 JUNIPER WAY	1100	1ST
1185	7 JUNIPER WAY	1100	1ST
1186	8 JUNIPER WAY	1100	2ND
1187	9 JUNIPER WAY	1100	3RD
1188	10 JUNIPER WAY	1100	1ST
1189	11 JUNIPER WAY	1100	2ND
1190	12 JUNIPER WAY	1100	3RD
1191	19 JUNIPER WAY	1100	3RD
1192	18 JUNIPER WAY	1100	2ND
1193	17 JUNIPER WAY	1100	1ST
1194	16 JUNIPER WAY	1100	3RD
1195	15 JUNIPER WAY	1100	2ND
1196	14 JUNIPER WAY	1100	1ST
1197	20 JUNIPER WAY	1100	1ST
1198	21 JUNIPER WAY	1100	2ND
1199	22 JUNIPER WAY	1100	3RD
1200	23 JUNIPER WAY	1100	1ST
1201	24 JUNIPER WAY	1100	2ND
1202	25 JUNIPER WAY	1100	3RD
1203	31 JUNIPER WAY	1100	3RD
1204	30 JUNIPER WAY	1100	2ND
1205	29 JUNIPER WAY	1100	1ST
1206	28 JUNIPER WAY	1100	3RD
1207	27 JUNIPER WAY	1100	2ND
1208	26 JUNIPER WAY	1100	1ST
1209	32 JUNIPER WAY	1100	1ST
1210	33 JUNIPER WAY	1100	2ND
1211	34 JUNIPER WAY	1100	3RD
1212	35 JUNIPER WAY	1100	1ST
1213	36 JUNIPER WAY	1100	2ND
1214	37 JUNIPER WAY	1100	3RD
1215	43 JUNIPER WAY	1100	3RD
1216	42 JUNIPER WAY	1100	2ND
1217	41 JUNIPER WAY	1100	1ST
1218	40 JUNIPER WAY	1100	3RD
1219	39 JUNIPER WAY	1100	2ND
1220	37 JUNIPER WAY	1100	1ST
1221	44 JUNIPER WAY	1100	1ST
1222	45 JUNIPER WAY	1100	2ND
1223	46 JUNIPER WAY	1100	3RD
1224	47 JUNIPER WAY	1100	1ST
1225	48 JUNIPER WAY	1100	2ND
1226	49 JUNIPER WAY	1100	3RD
1227	52 JUNIPER WAY	1100	3RD
1228	51 JUNIPER WAY	1100	2ND
1229	50 JUNIPER WAY	1100	1ST
1230	55 JUNIPER WAY	1100	3RD
1231	54 JUNIPER WAY	1100	2ND
1232	53 JUNIPER WAY	1100	1ST
1233	59 JUNIPER WAY	1100	1ST
1234	60 JUNIPER WAY	1100	2ND
1235	61 JUNIPER WAY	1100	3RD
1236	56 JUNIPER WAY	1100	1ST
1237	57 JUNIPER WAY	1100	2ND
1238	58 JUNIPER WAY	1100	3RD
1239	64 JUNIPER WAY	1100	3RD
1240	63 JUNIPER WAY	1100	2ND
1241	62 JUNIPER WAY	1100	1ST
1242	67 JUNIPER WAY	1100	3RD
1243	66 JUNIPER WAY	1100	2ND
1244	65 JUNIPER WAY	1100	1ST
1245	71 JUNIPER WAY	1100	1ST
1246	72 JUNIPER WAY	1100	2ND
1247	73 JUNIPER WAY	1100	3RD
1248	68 JUNIPER WAY	1100	1ST
1249	69 JUNIPER WAY	1100	2ND
1250	70 JUNIPER WAY	1100	3RD
819	2 ASPEN COURT	1100	1ST
820	6 ASPEN COURT	1100	2ND
821	7 ASPEN COURT	1100	3RD
822	5 ASPEN COURT	1100	1ST
823	3 ASPEN COURT	1100	2ND
824	4 ASPEN COURT	1100	3RD
825	10 ASPEN COURT	1100	3RD
826	9 ASPEN COURT	1100	2ND
827	8 ASPEN COURT	1100	1ST
828	14 ASPEN COURT	1100	3RD
829	12 ASPEN COURT	1100	2ND
830	11 ASPEN COURT	1100	1ST
831	18 ASPEN COURT	1100	1ST
832	19 ASPEN COURT	1100	2ND
833	20 ASPEN COURT	1100	3RD
834	15 ASPEN COURT	1100	1ST
835	16 ASPEN COURT	1100	2ND
836	17 ASPEN COURT	1100	3RD
837	23 ASPEN COURT	1100	3RD
838	22 ASPEN COURT	1100	2ND
839	21 ASPEN COURT	1100	1ST
840	26 ASPEN COURT	1100	3RD
841	25 ASPEN COURT	1100	2ND
842	24 ASPEN COURT	1100	1ST
843	30 ASPEN COURT	1100	1ST
844	31 ASPEN COURT	1100	2ND

LOT	LOCATION	SQ FT	FLOOR
845	32 ASPEN COURT	1100	3RD
846	27 ASPEN COURT	1100	1ST
847	28 ASPEN COURT	1100	2ND
848	29 ASPEN COURT	1100	3RD
849	35 ASPEN COURT	1100	3RD
850	34 ASPEN COURT	1100	2ND
851	33 ASPEN COURT	1100	1ST
852	38 ASPEN COURT	1100	3RD
853	37 ASPEN COURT	1100	2ND
854	36 ASPEN COURT	1100	1ST
855	42 ASPEN COURT	1100	1ST
856	43 ASPEN COURT	1100	2ND
857	44 ASPEN COURT	1100	3RD
858	39 ASPEN COURT	1100	1ST
859	40 ASPEN COURT	1100	2ND
860	41 ASPEN COURT	1100	3RD
861	47 ASPEN COURT	1100	3RD
862	46 ASPEN COURT	1100	2ND
863	45 ASPEN COURT	1100	1ST
864	50 ASPEN COURT	1100	3RD
865	49 ASPEN COURT	1100	2ND
866	48 ASPEN COURT	1100	1ST
867	51 ASPEN COURT	1100	1ST
868	52 ASPEN COURT	1100	2ND
869	53 ASPEN COURT	1100	3RD
870	54 ASPEN COURT	1100	1ST
871	55 ASPEN COURT	1100	2ND
872	56 ASPEN COURT	1100	3RD
873	62 ASPEN COURT	1100	3RD
874	61 ASPEN COURT	1100	2ND
875	60 ASPEN COURT	1100	1ST
876	59 ASPEN COURT	1100	3RD
877	58 ASPEN COURT	1100	2ND
878	57 ASPEN COURT	1100	1ST
879	63 ASPEN COURT	1100	1ST
880	64 ASPEN COURT	1100	2ND
881	65 ASPEN COURT	1100	3RD
882	66 ASPEN COURT	1100	1ST
883	67 ASPEN COURT	1100	2ND
884	68 ASPEN COURT	1100	3RD
885	74 ASPEN COURT	1100	3RD

SOCIETY HILL I - BLOCK 2167 LOT 818

818
 2167
 31.15 AC. +/-
 TOTAL
 COMMON ELEMENT
 4.001

SEE SHEET 137

SEE SHEET 137

SEE SHEET 135

SEE SHEET 139

SEE SHEET 138

SEE SHEET 135

SEE SHEET 138

SEE SHEET 139

REVISIONS		
DATE	NAME	LIC. No.
03/2019	VINCENT J. RIGELON, JR.	33111

LOT	LOCATION	SQ FT	FLOOR
886	73 ASPEN COURT	1100	2ND
887	72 ASPEN COURT	1100	1ST
888	71 ASPEN COURT	1100	3RD
889	70 ASPEN COURT	1100	2ND
890	69 ASPEN COURT	1100	1ST
891	20 MULBERRY COURT	1100	1ST
892	21 MULBERRY COURT	1100	2ND
893	22 MULBERRY COURT	1100	3RD
894	23 MULBERRY COURT	1100	1ST
895	24 MULBERRY COURT	1100	2ND
896	25 MULBERRY COURT	1100	3RD
897	19 MULBERRY COURT	1100	3RD
898	18 MULBERRY COURT	1100	2ND
899	17 MULBERRY COURT	1100	1ST
900	16 MULBERRY COURT	1100	3RD
901	15 MULBERRY COURT	1100	2ND
902	14 MULBERRY COURT	1100	1ST
903	7 MULBERRY COURT	1100	1ST
904	8 MULBERRY COURT	1100	2ND
905	9 MULBERRY COURT	1100	3RD
906	10 MULBERRY COURT	1100	1ST
907	11 MULBERRY COURT	1100	2ND
908	12 MULBERRY COURT	1100	3RD
909	6 MULBERRY COURT	1100	3RD
910	5 MULBERRY COURT	1100	2ND
911	4 MULBERRY COURT	1100	1ST
912	3 MULBERRY COURT	1100	3RD
913	2 MULBERRY COURT	1100	2ND
914	1 MULBERRY COURT	1100	1ST
915	28 MULBERRY COURT	1100	3RD
916	27 MULBERRY COURT	1100	2ND
917	26 MULBERRY COURT	1100	1ST
918	31 MULBERRY COURT	1100	3RD
919	30 MULBERRY COURT	1100	2ND
920	29 MULBERRY COURT	1100	1ST
921	35 MULBERRY COURT	1100	1ST
922	36 MULBERRY COURT	1100	2ND
923	37 MULBERRY COURT	1100	3RD
924	32 MULBERRY COURT	1100	1ST
925	33 MULBERRY COURT	1100	2ND
926	34 MULBERRY COURT	1100	3RD
927	40 MULBERRY COURT	1100	3RD
928	39 MULBERRY COURT	1100	2ND
929	38 MULBERRY COURT	1100	1ST
930	43 MULBERRY COURT	1100	3RD
931	42 MULBERRY COURT	1100	2ND
932	41 MULBERRY COURT	1100	1ST
933	47 MULBERRY COURT	1100	1ST
934	48 MULBERRY COURT	1100	2ND
935	49 MULBERRY COURT	1100	3RD
936	44 MULBERRY COURT	1100	1ST
937	45 MULBERRY COURT	1100	2ND
938	46 MULBERRY COURT	1100	3RD

LEGEND

- 1515 EXISTING BLOCK NUMBER
- 3-9 FORMER BLOCK NUMBER
- 432 FORMER LOT NUMBER
- STATE BOUNDARY
- - - MUNICIPAL BOUNDARY
- COUNTY BOUNDARY
- ||||| ASSESSED AREA LIMIT LINE

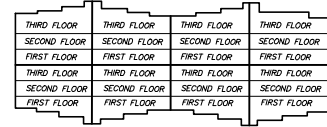

SEE SHEET 138

NEW JERSEY DEPARTMENT OF THE TREASURY
 DIVISION OF TAXATION
 APPROVED AS A TAX MAP PURSUANT
 TO THE AUTHORITY OF
 N.J.S.A. 54:1-15 AND N.J.S.A. 54:50-1
 FOR THE DIRECTOR, DIVISION OF TAXATION
 SIGNED BY SUE DAWSON, CTA
 SUPERVISING FIELD REP
 DATED AUGUST 14, 2014 SERIAL # 1043

TAX MAP
TOWNSHIP OF HAMILTON
 MERCER COUNTY, NEW JERSEY
 SCALE 1" = 50' APRIL, 1996
MICHAEL GUERRIERO, P.L.S.
 T & M ASSOCIATES
 11 TINDALL ROAD, MIDDLETOWN TOWNSHIP
 NEW JERSEY, 07748
 TO SHOW CONDITIONS AS OF JULY 14, 2014