

REVISIONS		
DATE	NAME	LIC. No.
02/2020	WINCENT J. RIGELON, JR.	33111

SEE SHEET 171

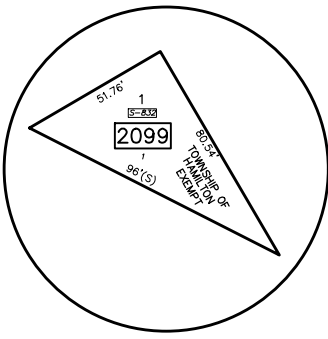
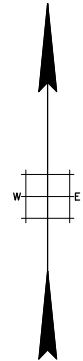

SEE SHEET 171

SEE SHEET 173

LEGEND

- 1515 EXISTING BLOCK NUMBER
- 5-5 FORMER BLOCK NUMBER
- 4.32 FORMER LOT NUMBER
- STATE BOUNDARY
- MUNICIPAL BOUNDARY
- COUNTY BOUNDARY
- ||||| ASSESSED AREA LIMIT LINE



SEE SHEET 171

SEE SHEET 195

SEE SHEET 193

CITY OF TRENTON
MERCER COUNTY

SEE SHEET 193

SEE SHEET 193

SEE SHEET 193

SEE SHEET 194

NEW JERSEY DEPARTMENT OF THE TREASURY
DIVISION OF TAXATION
APPROVED AS A TAX MAP PURSUANT
TO THE AUTHORITY OF
N.J.S.A. 54:1-15 AND N.J.S.A. 54:50-1
FOR THE DIRECTOR, DIVISION OF TAXATION

SIGNED BY SUE DAVDSON, CTA
SUPERVISING FIELD REP

DATED AUGUST 14, 2014 SERIAL # 1043

TAX MAP
TOWNSHIP OF HAMILTON
MERCER COUNTY, NEW JERSEY
SCALE 1"= 50' APRIL, 1996
MICHAEL GUERRIERO, P.L.S.
T & M ASSOCIATES
11 TINDALL ROAD, MIDDLETOWN TOWNSHIP
NEW JERSEY, 07748
"TO SHOW CONDITIONS AS OF JULY 14, 2014"